



Manhole Inspection Form

M2-32-P1-32N-P2-15E-3-1N



Manhole Number	M2-32-P1-32N-P2-15E-3-1N	Historic Manhole Number	Compass Pointe 1
Year Installed	1968	Structure Type	Sanitary Manhole
Street	Lotties	Address	49600
Elevation	582.733	Weather	Snowing
Temperature	30°	Ground Condition	Damp
Status	At Surface Grade	Location	Yard Front
Pavment Condition	<null>	Traffic	Two Lane Road
Inspector 1	Brs	Inspector 2	Kmd
Cover Type	Ej1040a	Number of Cover Holes	Solid Cover
Catch Basin Cover	<null>	Cover Insert	No
Cover Gasket	No	Cover Grade	Cover is Below Grade
Grade Dist	6	Cover Fit	Good Fit
Cover Condition	Good	Frame Condition	Good
Frame Offset	<null>	Frame Seal Condition	Fair
Frame Seal Inflow	None	Frame Riser	No
Frame Riser Height	<null>	Frame Riser Material	N/A
Manhole Diameter	48	Manhole Depth	12.75
Chimney Depth	<null>	Chimney Construction	None
Chimney Condition	<null>	Chimney Inflow	<null>
Cone Shape	Eccentric	Cone Depth	36
Cone Construction	Precast	Cone Condition	Good
Cone Inflow	None	Cone Defect Location	<null>
Wall Construction	Precast	Wall Condition	Good
Wall Inflow	None	Wall Defect Location	<null>
Wall Defect Location 2	<null>	Wall Defect Location 3	<null>
Wall Defect Location 4	<null>	Wall Defect Location 5	<null>
Bench Construction	Poured	Bench Condition	Good
Bench Inflow	None	Channel Construction	Poured
Channel Condition	Good	Channel Inflow	None
Channel Hydraulics	Good	Channel Exposure	Yes

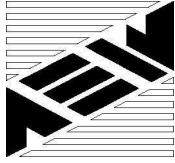

Manhole Inspection Form

M2-32-P1-32N-P2-15E-3-1N



Step Construction	Iron	Step Condition	Fair
Surcharge Evidence	<null>		
Pipe 1 Flow	Inward Flow	Pipe 1 Diameter	12
Pipe 1 Direction	NE	Pipe 1 Depth	12.6
Pipe 1 Material	Concrete	Pipe 1 Seal Condition	Good
Pipe 1 Drop	<null>	Pipe 1 Comments	<null>
Pipe 2 Flow	Outward Flow	Pipe 2 Diameter	12
Pipe 2 Direction	SW	Pipe 2 Depth	12.75
Pipe 2 Material	Concrete	Pipe 2 Seal Condition	Good
Pipe 2 Drop	<null>	Pipe 2 Comments	<null>
Pipe 3 Flow	<null>	Pipe 3 Diameter	<null>
Pipe 3 Direction	<null>	Pipe 3 Depth	<null>
Pipe 3 Material	<null>	Pipe 3 Seal Condition	<null>
Pipe 3 Drop	<null>	Pipe 3 Comments	<null>
Pipe 4 Flow	<null>	Pipe 4 Diameter	<null>
Pipe 4 Direction	<null>	Pipe 4 Depth	<null>
Pipe 4 Material	<null>	Pipe 4 Seal Condition	<null>
Pipe 4 Drop	<null>	Pipe 4 Comments	<null>
Pipe 5 Flow	<null>	Pipe 5 Diameter	<null>
Pipe 5 Direction	<null>	Pipe 5 Depth	<null>
Pipe 5 Material	<null>	Pipe 5 Seal Condition	<null>
Pipe 5 Drop	<null>	Pipe 5 Comments	<null>
Pipe 6 Flow	<null>	Pipe 6 Diameter	<null>
Pipe 6 Direction	<null>	Pipe 6 Depth	<null>
Pipe 6 Material	<null>	Pipe 6 Seal Condition	<null>
Pipe 6 Drop	<null>	Pipe 6 Comments	<null>
Recommendation 1	<null>	Recommendation 2	<null>
Recommendation 3	<null>	Recommendation 4	<null>
Recommendation 5	<null>	Recommendation 6	<null>

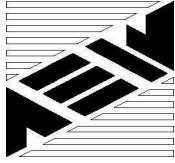

Manhole Inspection Form

M2-32-P1-32N-P2-15E-3-1N



Recommendation 7	<null>	Recommendation 8	<null>
Manhole Rating	2 – Failure unlikely in 20 years (Good)	Comments	Buried 6"

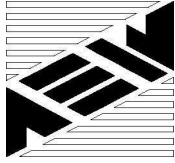

Manhole Inspection Form

M2-32-P1-32N-P2-15E-3-1N





Manhole Inspection Form

M2-32-P1-32N-P2-15E-3-1N



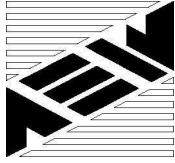

Manhole Inspection Form

M2-32-P1-32N-P2-15E-3-1N



51301 Schoenherr Road, Shelby Township, Michigan 48315
Civil Engineers • Surveyors • Architects 586-726-1234

Page: 6

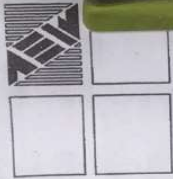

Manhole Number: M2-32-P1-32N-P2-15E-3-1N

Community: Chesterfield

Inspector Initials: KMD / BRS

Date: 12/8/16

Address: 49600 Lotties

R.T. = 12.75

D = 48"

Map: 50



STR ON COMPASS

16.25	16.25
-3.50	-3.65
12.75	12.60

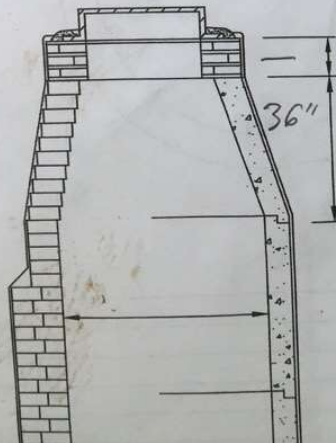
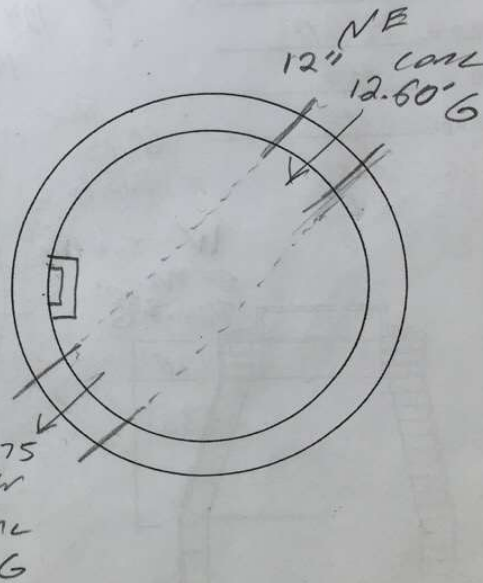

code: 6/4/2016 7:08:23 AM



Manhole Inspection Form

M2-32-P1-32N-P2-15E-3-1N

